



1239 Hyde Lane,  
Richmond, Virginia 23229  
(804) 750-1870

GRAYSONHILL.COM

# Hamstead



Located at the corners of our Executive buildings, the Hamstead makes for a peaceful, intimate home. It features grand ten-foot ceilings on the ground floor and nine-foot ceilings on the second floor. The second-floor owner's suite features a charming sitting room, luxurious bath and large walk-in closet.

## STANDARD FEATURES

- 10' ceilings on ground floor
- Gas fireplace with slate hearth and surround
- Soaking tub and shower with ceramic tile surround in owner's suite
- Professionally designed kitchen
- Kitchen appliances by GE®
- Dual-zone heating and air conditioning systems
- Modern interior fire suppression system
- Two-car garage with remote entry
- Brick and Hardiplank® siding (per plan)
- Professional landscaping and lawn maintenance

Grayson Hill recalls a time when gentility reigned and skilled craftsmen took pride in their work. Each custom home embodies these traditions while meeting the exacting demands of today's luxury homeowner.



**1<sup>ST</sup>** GROUND FLOOR  
Ceilings: 10'

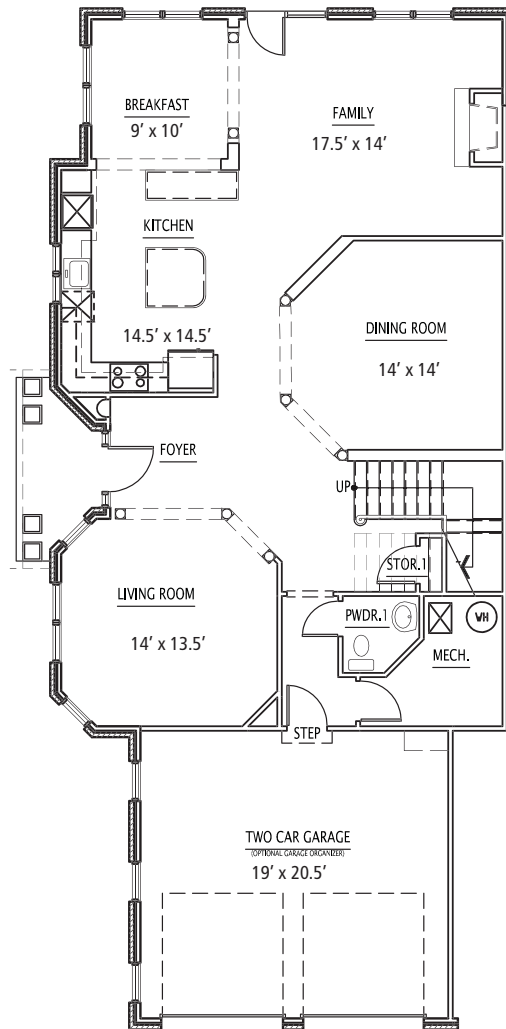

**2<sup>ND</sup>** SECOND FLOOR  
Ceilings: 9'

